

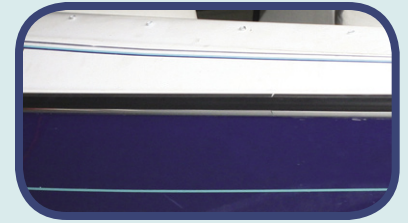

RUB RAIL Aluminum



Aluminum

Aluminum rub rail provides strength and protection and gives boats a classic look. Manufactured from high grade 6063-T5 aluminum alloy, it tempers for easy tight radius bending. The anodized finish allows protection in the harshest marine environment.

- Designed for use without an insert
- Polished clear anodized finish
- Drilled and countersunk on 6" centers

A1 1-0514

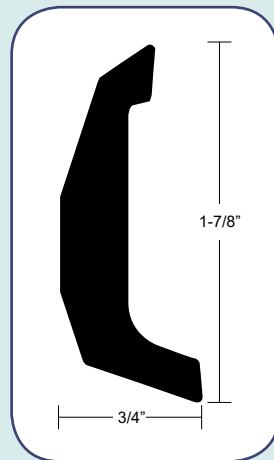

A11-0514
Aluminum Rub Rail

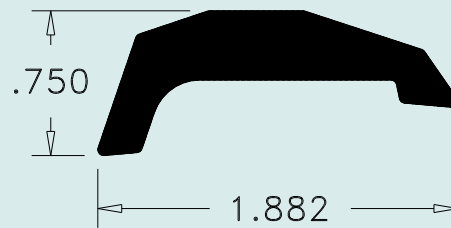

Bulk	Retail	Length	Height	Width	Screws
A11-0514TAL20D	-	20'	1-7/8"	3/4"	#10

