



# RUB RAIL

## Rigid Vinyl



### Rigid Vinyl

Rigid vinyl rub rail tightly forms to the boats' contours and has exceptional lasting qualities in the most adverse conditions.

- Color and gloss levels matched to gel coats blending rub rail with hull and deck
- Requires heat for radius forming
- Cuts and drills like wood
- Designed for use without an insert
- Provides good basic protection
- Ideal for work boats
- Drilled and countersunk on 8" centers

### V21-3670

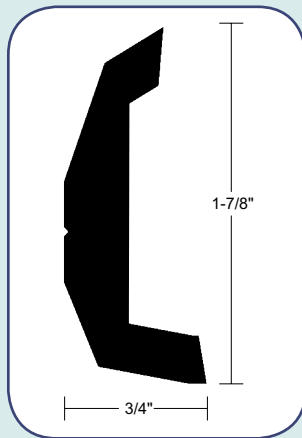

V21-3670  
Rigid Rub Rail

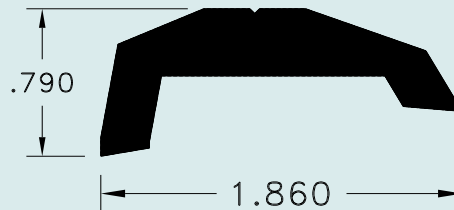

F90-0001  
End Cap

Bulk	Retail*	Color	Length	Height	Width	Screws	End Caps
V21-3670BKA20D	V21-3670BKA20D-1	BKA	20'	1-7/8"	3/4"	#10*	F90-0001
V21-3670WHA20D	V21-3670WHA20D-1	WHA	20'	1-7/8"	3/4"	#10*	F90-0001

